

## QDI5050A

### High Power, High Isolation

#### Features:

- \* High Power
- \* High Isolation
- \* Low Insertion Loss
- \* Low VSWR

#### Applications:

- \* Wireless
- \* Radar
- \* Laboratory Test

#### Description

QDI5050A series Drop-In Isolators cover frequency range 1500~3000MHz. High power, high isolation and low insertion loss make it ideal for a lot of applications like amplifiers, transceivers, etc.

#### Specifications

Frequency (MHz)	Bandwidth (MHz)	Insertion Loss (dB Max.)	Isolation (dB Min.)	VSWR (Max.)	Fwd Power (W Max.)	Rev Power (W)	Temperature (°C)
1500~3000	1500	0.7	17.0	1.40	100	10~100	-10~+60

#### Outline Drawings

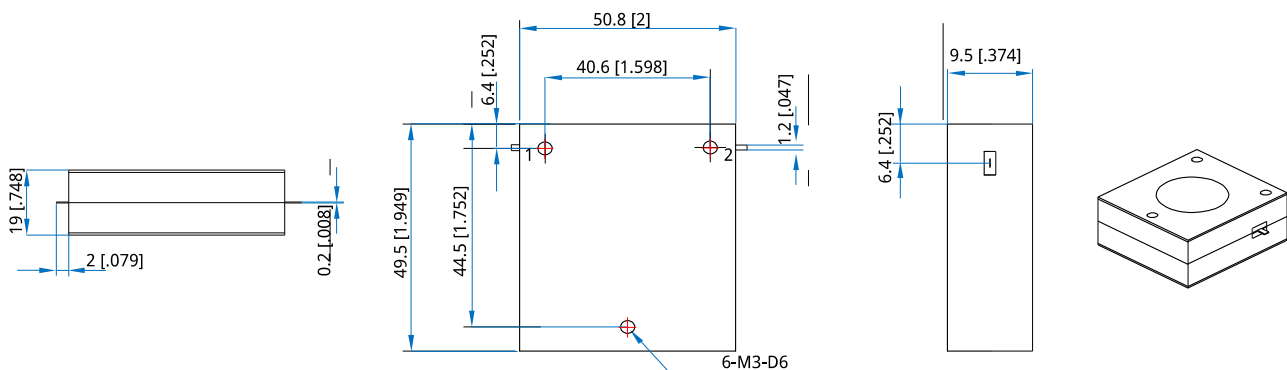

Unit: mm [inch]      Tolerance:  $\pm 0.2\text{mm}$  [ $\pm 0.008\text{in}$ ]

#### Mechanical

Size<sup>\*1</sup>: 50.8\*49.5\*19mm  
2\*1.949\*0.748in  
Connector Type: Strip line  
Mounting: 6-M3, depth 6mm

[1] Exclude connectors and terminations.

#### Direction Naming Rules:

- 1 - Clockwise
- 2 - Anticlockwise

#### How To Order

##### QDI5050A-V-W-X-Y-Z

V: Start frequency in MHz  
W: Stop frequency in MHz  
X: Forward Power in W  
Y: Reverse Power in W  
Z: Direction type

#### Examples:

To order a QDI5050A series Isolator, 1500~3000MHz, Forward power 100W, Reverse power 10W, Clockwise, specify QDI5050A-1500-3000-K1-10-1.

Customization is available upon request.